

Underground **Machine Parts**



Bend-tech.
ENGINEERED TOUGH



Table of Contents

REPLACEMENT PARTS	3
CAT 2900 LOADER	4-8
CAT 3000 LOADER	8-9
CAT 1700 LOADER	10-11
CAT AD30 TRUCK	12-13
CAT AD45 TRUCK	14-15
CAT D55DNW TRUCK	16-17
CAT D55JNW TRUCK	18-19
ATLAS MT65 TRUCK	20-21
ATLAS MT602 TIER 2 TRUCK	22-23
SANDVIK LH621 LOADER	24-25
SANDVIK TH663 / TH551 TRUCK	26-31
ALLTUFF STANDS	32
WORKSHOP TRESTLES AND BENCHES	33
GENERAL PURPOSE STEEL RACK	34
CDEC PROCESS	35

“ Making maintenance on-site safe, efficient and easy ”

Replacement Parts

Bend-tech replacement parts are designed to suit specific underground machines. Our products are engineered to improve the safety and efficiency of underground operations and working at heights scenarios.

Safety

Our handrails are easily engaged and folded to ensure operators can maintain the critical 3-points of contact at all times. Kick plates incorporated into most handrails to minimise drop hazards from the deck. Our replacement parts have been designed with the safety of the operators and those in the surrounding work areas at the forefront.

Engineered Tough

All of our underground machinery replacement parts have been designed and engineered to comply with the relevant Australian Standard.

Environmentally Resistant

A heavy-duty zinc coating provides our parts with corrosion protection, followed by a safety yellow topcoat or machine specific colours.

Unrivalled Economy

Our low-folding handrails prevent damage, which reduces the chance of needing replacement. We are able to deliver our high performance, high quality replacement parts at a significant saving when compared to OEM parts.

Improved Hinge Design

Our field studies have yielded a hinge system that far exceeds the performance of the OEM hinge system. Constructed out of stainless steel to ensure corrosion resistance and improved functionality, our hinge system allows operators to easily engage and fold our handrails.

IMPROVED HINGE

Patent Pending and Registered Design



CAT2900 Loader

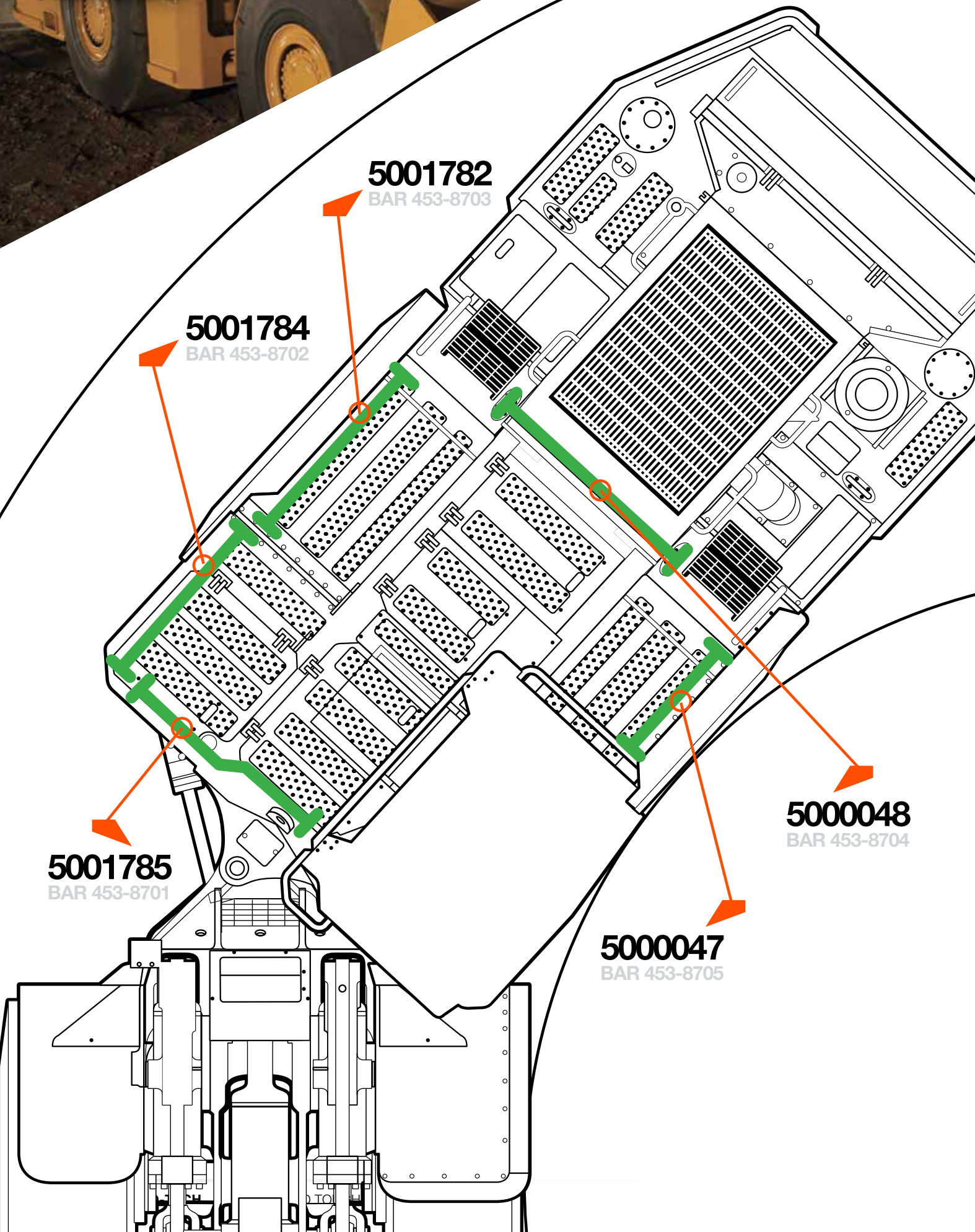

CAT2900 Loader



HANDRAIL 5001782

OEM No. 453-8703 (OLD 321-4739)



HANDRAIL 5000047

OEM No. 453-8705 (OLD 321-4745)



HANDRAIL 5000048

OEM No. 452-8704 feet attached (OLD 321-4753)



HANDRAIL 5001784

OEM No. 453-8702 (OLD 321-4758)



HANDRAIL 5001785

OEM No. 453-8701 (OLD 321-4767)



HANDRAIL 5000330

OEM No. 230-9812 (Not included in full set)

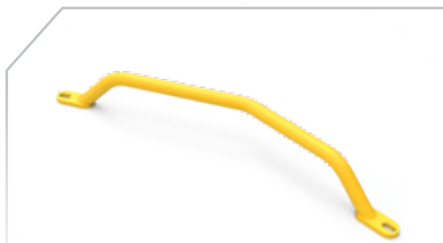

CAB HANDRAIL 5001816

OEM No. 250-0931 (Not included in full set)



FENDER 5001787

OEM No. AS-RH 230-9241



FENDER 5001788

OEM No. AS-LH 230-9240



CYLINDER GUARD 5001789

OEM No. Cylinder Guard - 217-0347

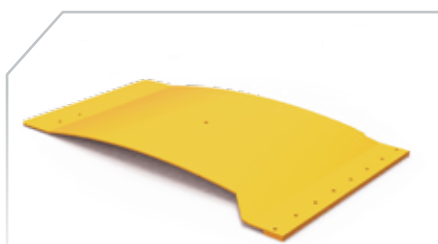

REAR GUARD RH 5000334

OEM No. 252-5933



WINDOW GUARD 5000331

OEM No. 251-7851



COVER - LUBRICATION LINES 5000333

OEM No. 203-1563

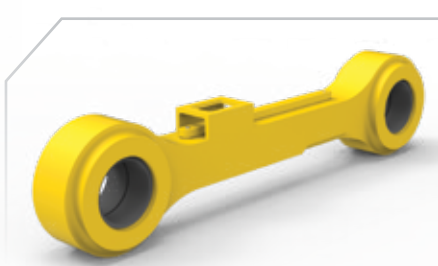

DOG BONE 5001783

OEM No. 186-9869 Link-tilt



BUCKET BUMPER 5000332

OEM No. 233-0734

CAT LOADER 2900 FULL SET PART NO: 5001786* *INCLUDES MAIN DECK HANDRAILS ONLY

CAT2900 Loader



CAT2900 Door

To suit Caterpillar 2900 JLK Machines
Part No. 249-6759

Part No. 5001791

Benefits include:

- Heavy duty construction
- Significant savings which takes away the need for downtime while repairing damaged doors
- Can be supplied with seals and glass
- Precision manufactured for fast fit up to your machine



TAILSHAFT GUARD BOTTOM 5001947

OEM No. 248-5140

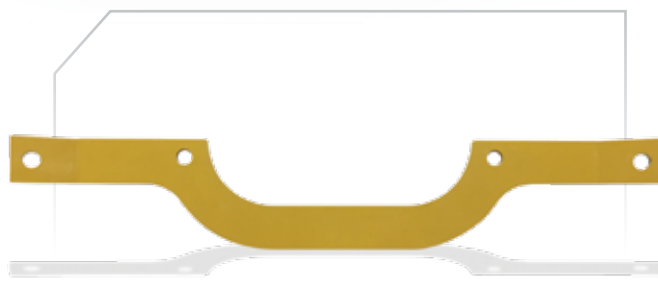

TAILSHAFT GUARD TOP 5001948

OEM No. 248-5139

CAT2900 Folding Guards

Made to suit CAT 2900 Loaders, our fender acts as a wheel guard and is designed to withstand the harshest underground mining environments.

Benefits include:

- Heavy duty hinged folding system
- Double pin design to eliminate sagging
- No need to take off the fender when servicing behind the wheel guard
- Stainless pins with greasing points
- Patent pending

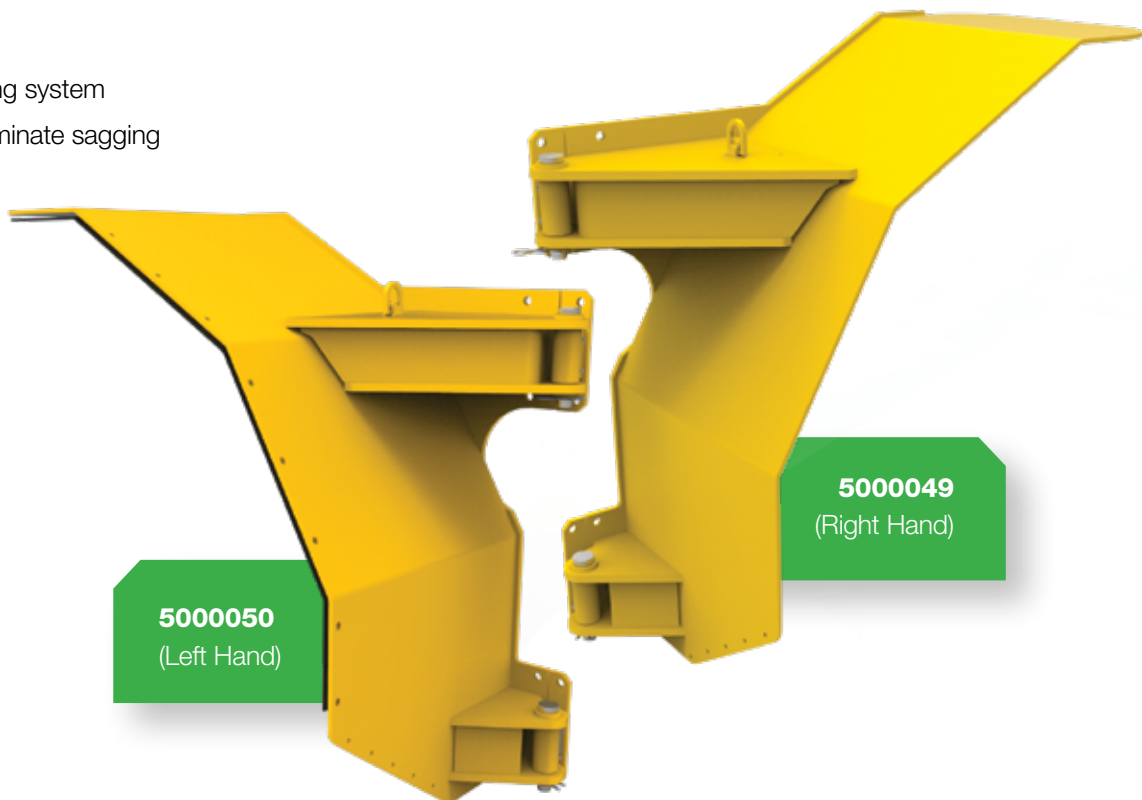

CAT2900 Dog Bone

Bend-tech's Dog Bone components are precision manufactured and machined from high tensile steel, with hardened and ground bushes. To suit OEM Part No. 186-9869

Part No. 5001783

Benefits include:

- Constructed in one piece to increase strength
- Grease channels underneath to prevent rock damage
- Grease channel machined into the dogbone body
- Patent pending

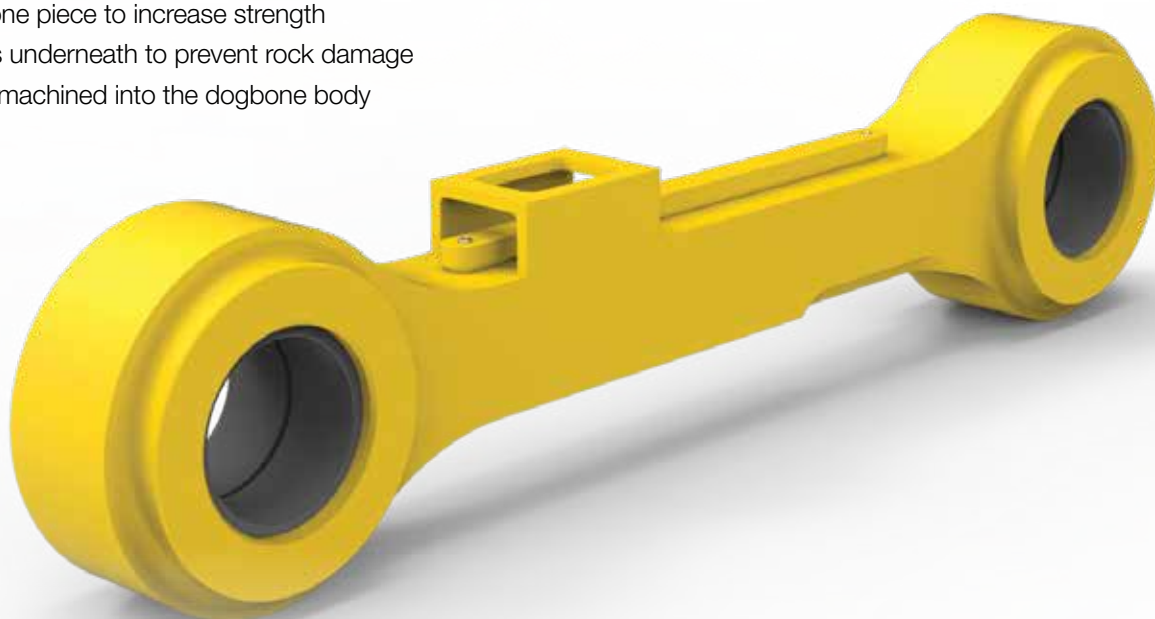

CAT3000 Loader

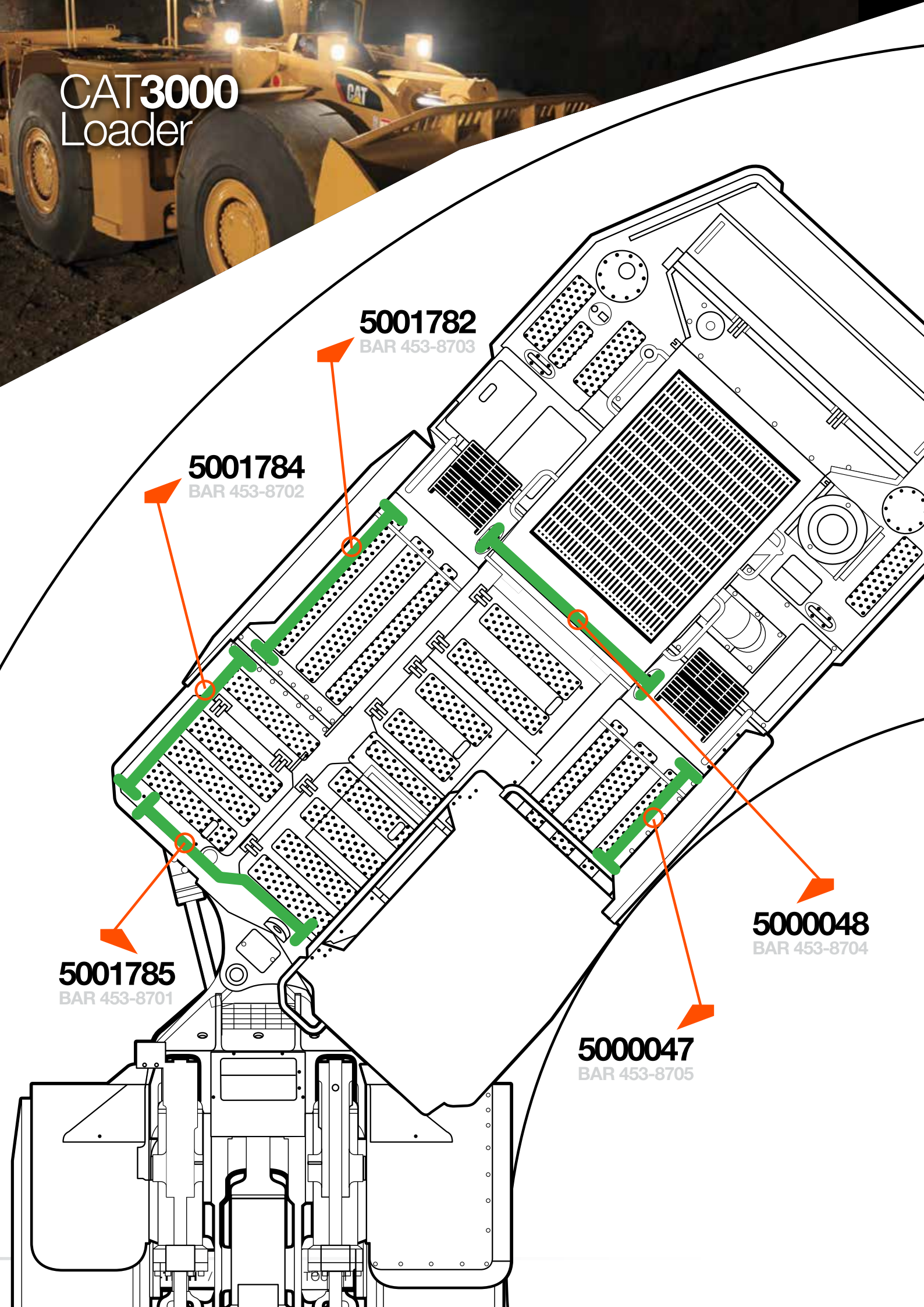

CAT3000 Loader



HANDRAIL 5001782

OEM No. 453-8703 (OLD 321-4739)



HANDRAIL 5000047

OEM No. 453-8705 (OLD 321-4745)



HANDRAIL 5000048

OEM No. 452-8704 feet attached (OLD 321-4753)



HANDRAIL 5001784

OEM No. 453-8702 (OLD 321-4758)



HANDRAIL 5001785

OEM No. 453-8701 (OLD 321-4767)

CAT LOADER 3000 FULL SET PART NO: 5001786



CAT1700 Loader

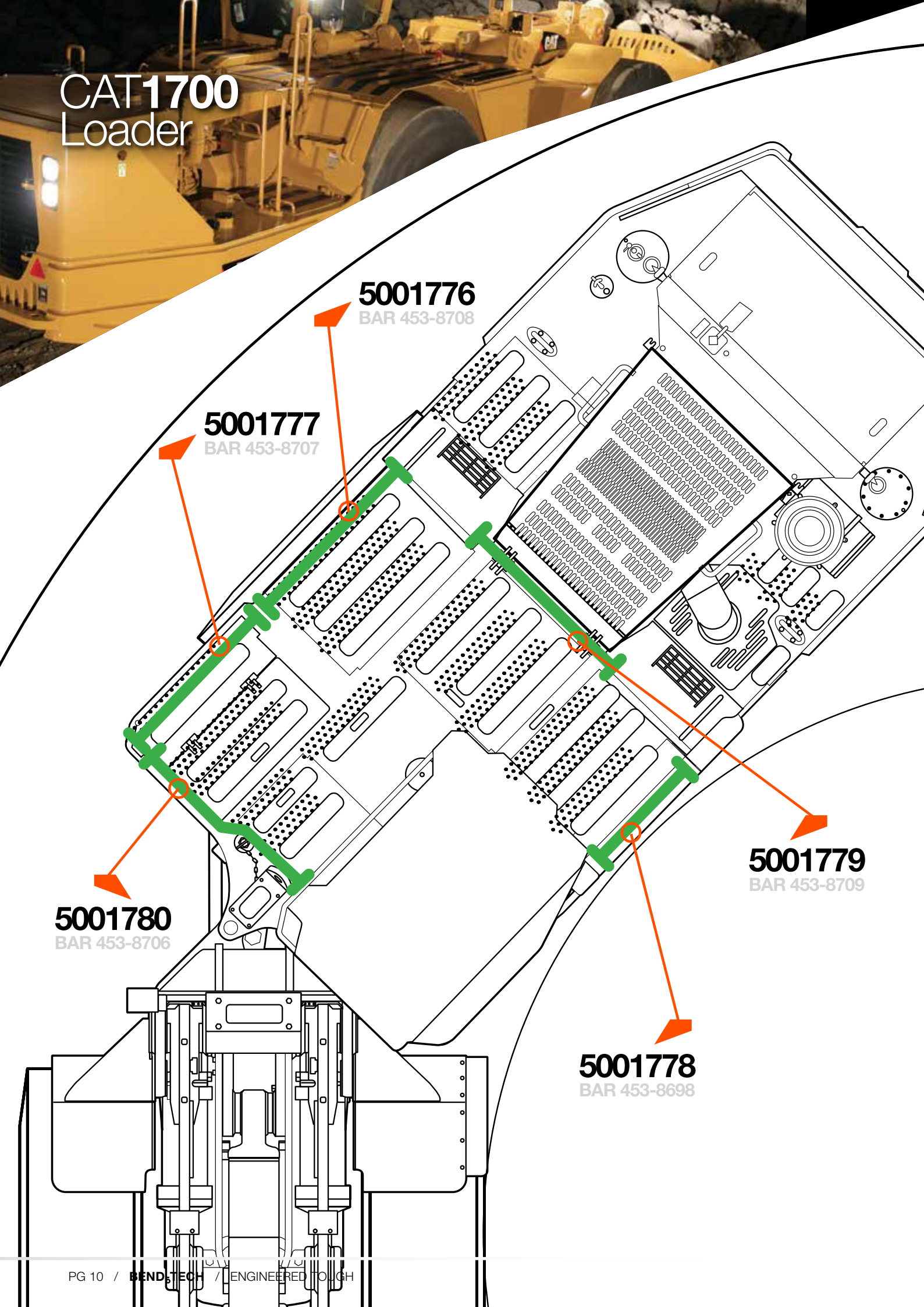

CAT1700 Loader



HANDRAIL 5001776
OEM No. 453-8708 (OLD 318-7892)



HANDRAIL 5001777
OEM No. 453-8707 (OLD 318-7901)



HANDRAIL 5001778
OEM No. 453-8698 (OLD 318-7896)



HANDRAIL 5001779
OEM No. 453-8709 feet attached (OLD 318-7885)



HANDRAIL 5001780
OEM No. 453-8706 (OLD 318-7853)



HANDRAIL 5000330
OEM No. 230-9812



TILT CYLINDER GUARD 5001946
OEM No. 199-5816



*** CAB DOOR AS 5001817**
OEM No. 291-0662 (Illustration purposes only)



*** DOG BONE 5001955**
OEM No. 186-9866

CAT LOADER 1700 FULL SET PART NO: 5001781 *EXCLUDES DOOR, TILT CYLINDER GUARD AND DOG BONE



CATAD30 Truck

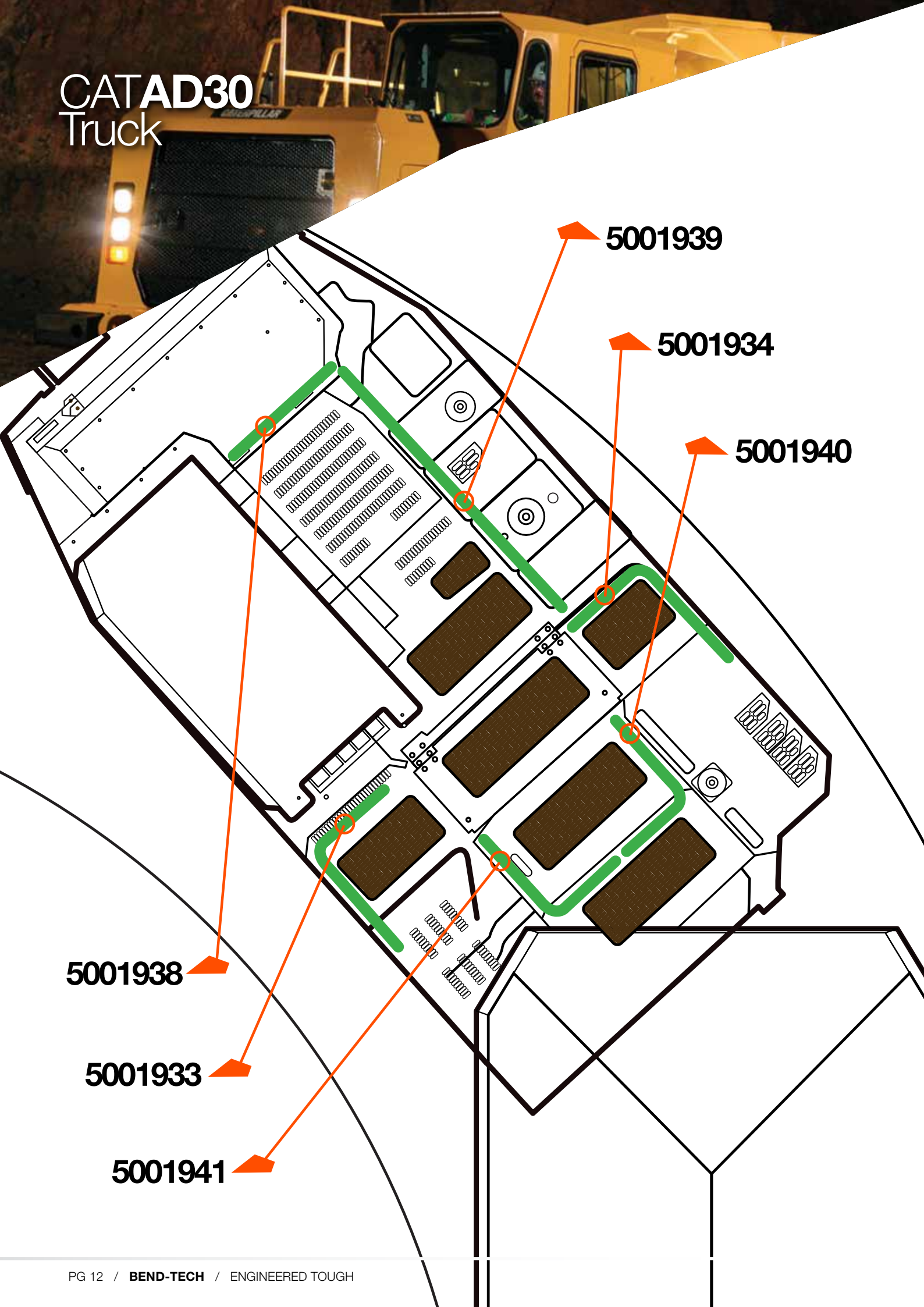

5001939

5001934

5001940

5001938

5001933

5001941

CAT **AD30** TRUCK



FRONT HANDRAIL 5001938



LH REAR HANDRAIL 5001941



RH REAR HANDRAIL 5001940



RH FRONT HANDRAIL 5001939



LH OUTER HANDRAIL 5001933



RH OUTER HANDRAIL 5001934

CAT TRUCK AD30 FULL SET PART NO: 5001960



CATAD45 Truck



CAT **AD45** TRUCK



HANDRAIL 5000055

OEM No. 245-2160



HANDRAIL 5000056

OEM No. 245-2161



HANDRAIL 5001922

OEM No. 271-1840



HANDRAIL 5001923

OEM No. 271-1841



HANDRAIL 5001924

OEM No. 271-1842



BUMPER 5001935

OEM No. 166-4225 (single unit)

CAT TRUCK AD45 FULL SET PART NO: 5001925* **EXCLUDES BUMPERS*



CAT AD55 DNW Truck

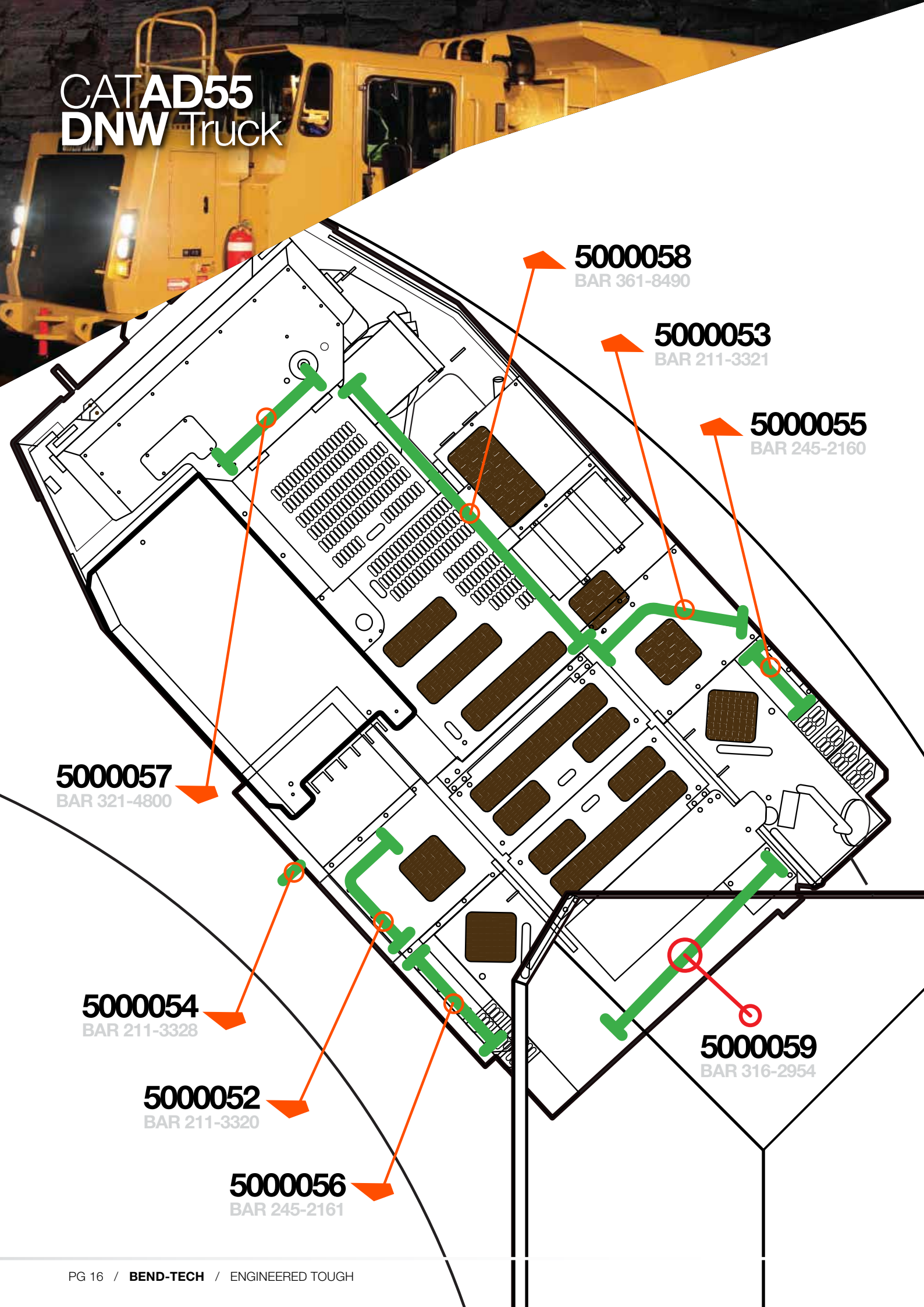

5000058
BAR 361-8490

5000053
BAR 211-3321

5000055
BAR 245-2160

5000057
BAR 321-4800

5000054
BAR 211-3328

5000052
BAR 211-3320

5000056
BAR 245-2161

5000059
BAR 316-2954

CAT AD55 DNW TRUCK



HANDRAIL 5000052

OEM No. 211-3320



HANDRAIL 5000053

OEM No. 211-3321



HANDRAIL 5000054

OEM No. 211-3328



HANDRAIL 5000055

OEM No. 245-2160



HANDRAIL 5000056

OEM No. 245-2161



HANDRAIL 5000057

OEM No. 321-4800 Offset Feet



HANDRAIL 5000058

OEM No. 361-8490



HANDRAIL 5000059

OEM No. 316-2954



BUMPER 5001935

OEM No. 166-4225 (single unit)

CAT TRUCK AD55-DNW FULL SET PART NO: 5000060*

**EXCLUDES BUMPERS*

CAT AD55 JNW Truck

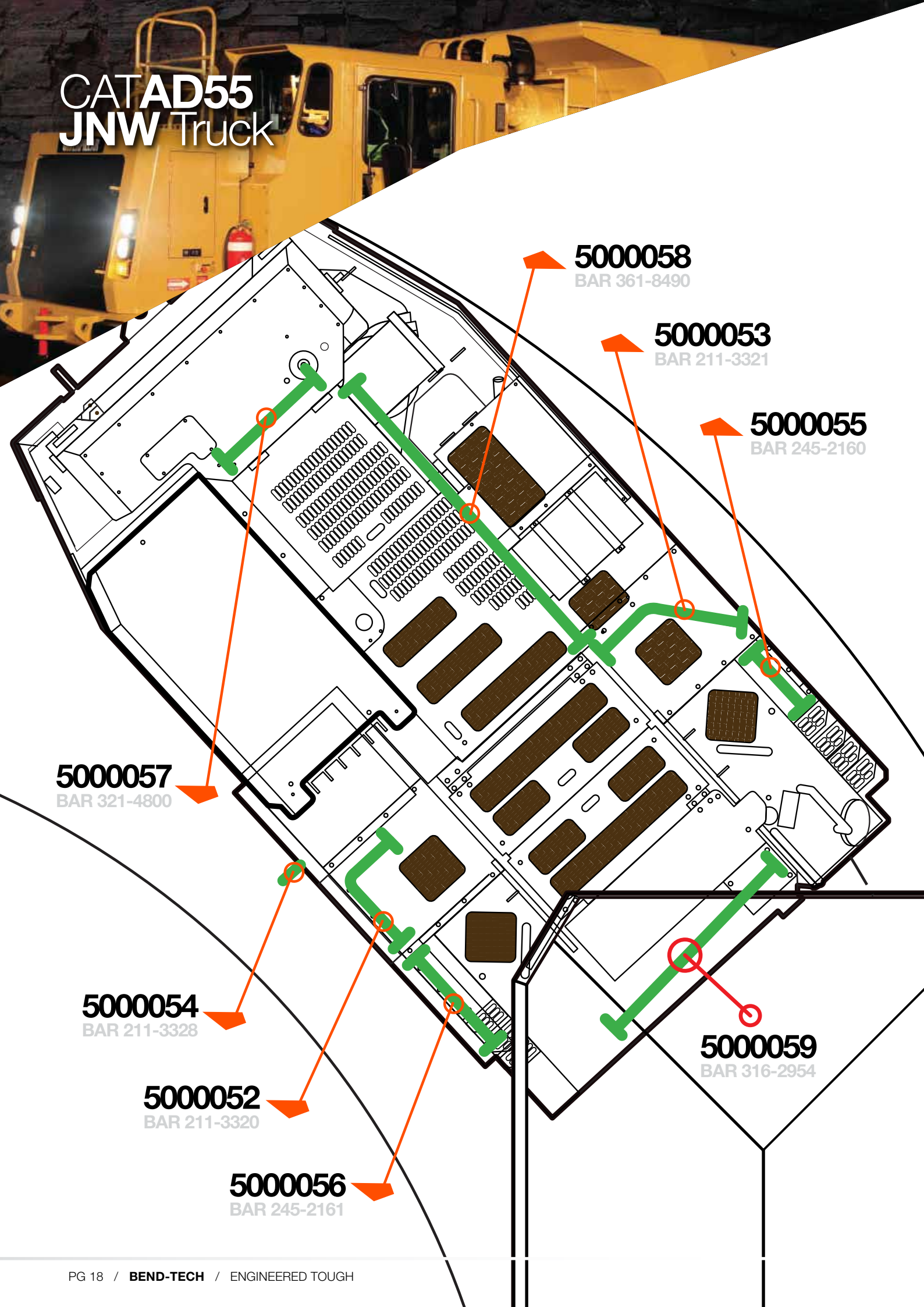

5000058
BAR 361-8490

5000053
BAR 211-3321

5000055
BAR 245-2160

5000057
BAR 321-4800

5000054
BAR 211-3328

5000052
BAR 211-3320

5000056
BAR 245-2161

5000059
BAR 316-2954

CATAD55 JNW TRUCK



HANDRAIL 5000054

OEM No. 211-3328



HANDRAIL 5000055

OEM No. 245-2160



HANDRAIL 5000056

OEM No. 245-2161



HANDRAIL 5000064

OEM No. 304-6145



HANDRAIL 5000065

OEM No. 313-2827



HANDRAIL 5000066

OEM No. 304-6148



HANDRAIL 5000067

OEM No. 313-3123



HANDRAIL 5000068

OEM No. 313-3146 Straight Feet



HANDRAIL 5000059

OEM No. 316-2954



HANDRAIL 5000070

OEM No. 310-4990



LADDER 5000046

OEM No. 338-6547



BUMPER 5001935

OEM No. 166-4225 (single unit)

CAT TRUCK AD55-JNW FULL SET PART NO: 5000071*

**EXCLUDES BUMPERS AND LADDER*

ATLAS MT65 Truck

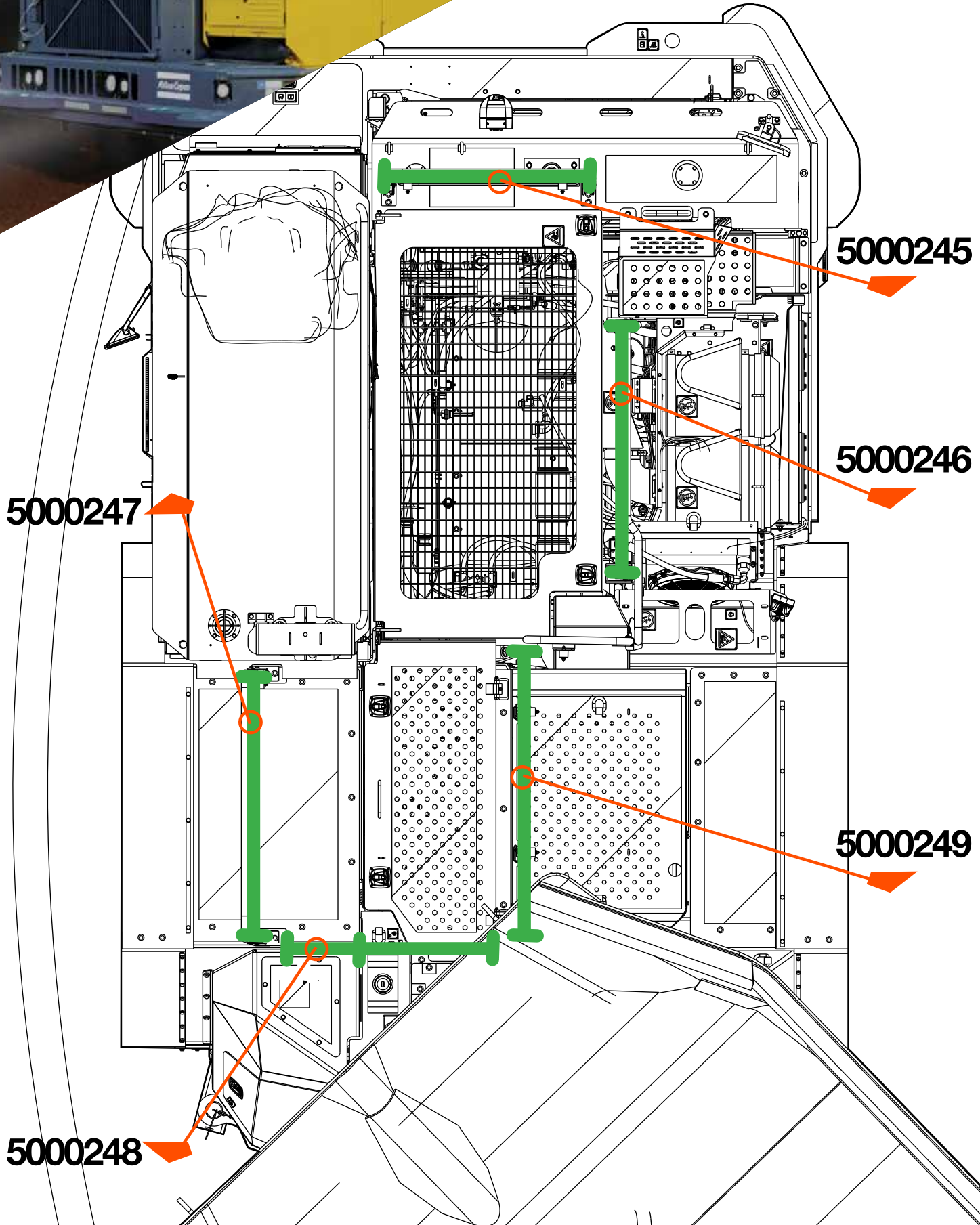

ATLAS **MT65** TRUCK



HANDRAIL 5000245



HANDRAIL 5000246



HANDRAIL 5000247



HANDRAIL 5000248



HANDRAIL 5000249

ATLAS TRUCK MT65 FULL SET PART NO: 5000250



ATLASMT6020 Truck - Tier 2

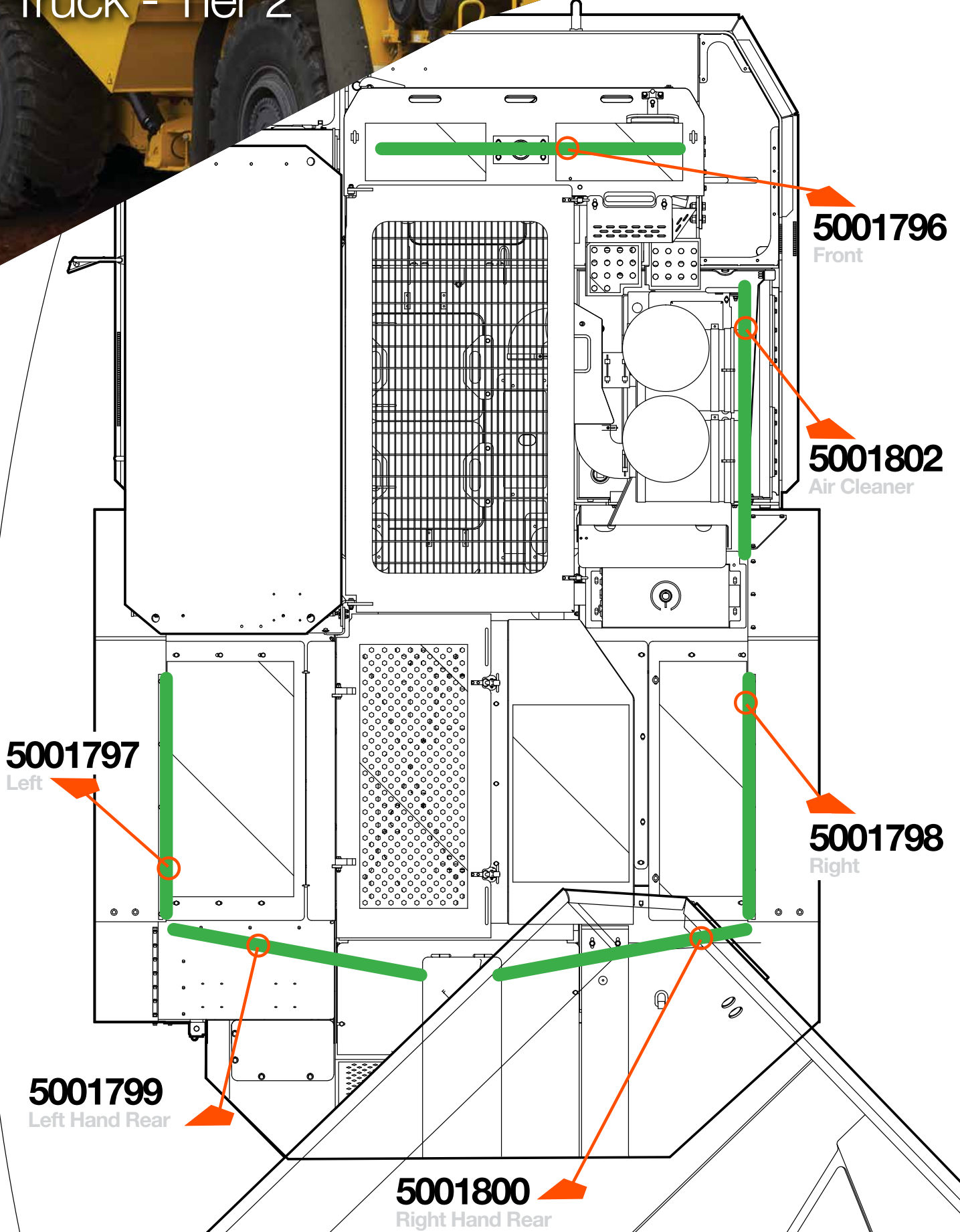

ATLAS **MT6020 TIER 2** TRUCK



HANDRAIL 5001796



HANDRAIL 5001797



HANDRAIL 5001798



HANDRAIL 5001799



HANDRAIL 5001800



HANDRAIL 5001802



HANDRAIL 5001930

* PLEASE NOTE: THESE HANDRAIL IS DESIGNED FOR TRUCK THAT HAS RENCOOL AIR CON UNIT FITTED

ATLAS TRUCK MT6020 TIER 2 FULL SET PART NO: 5001804*

**EXCLUDES PART NO. 5001930*



SANDVIK **LH621** LOADER



HANDRAIL 5000120

OEM No. 56018767



HANDRAIL 5000121

OEM No. 56018768



HANDRAIL 5000133

OEM No. 56018764



HANDRAIL 5000123

OEM No. 56018762



HANDRAIL 5000125

OEM No. 56018761



HANDRAIL 5000122

OEM No. 56018765



HANDRAIL 5000127

OEM No. 56018760



HANDRAIL 5000129

OEM No. 56018763



HANDRAIL 5000132

OEM No. 56018766

SANDVIK LH621 LOADER FULL SET PART NO: 5000141



SANDVIK LH621 Loader



HANDRAIL 5000126
OEM No. 56019161



SUPPORT BRACKET 5000135
OEM No. 56018774



SUPPORT BRACKET 5000134
OEM No. 56018773



SUPPORT BRACKET 5000131
OEM No. 56018771



SUPPORT BRACKET 5000130
OEM No. 56018772



SUPPORT BRACKET 5000128
OEM No. 56018770



SUPPORT BRACKET 5000124
OEM No. 56018769

SANDVIK LH621 LOADER FULL SET PART NO: 5000141

SANDVIK
TH663 TH551
TRUCK

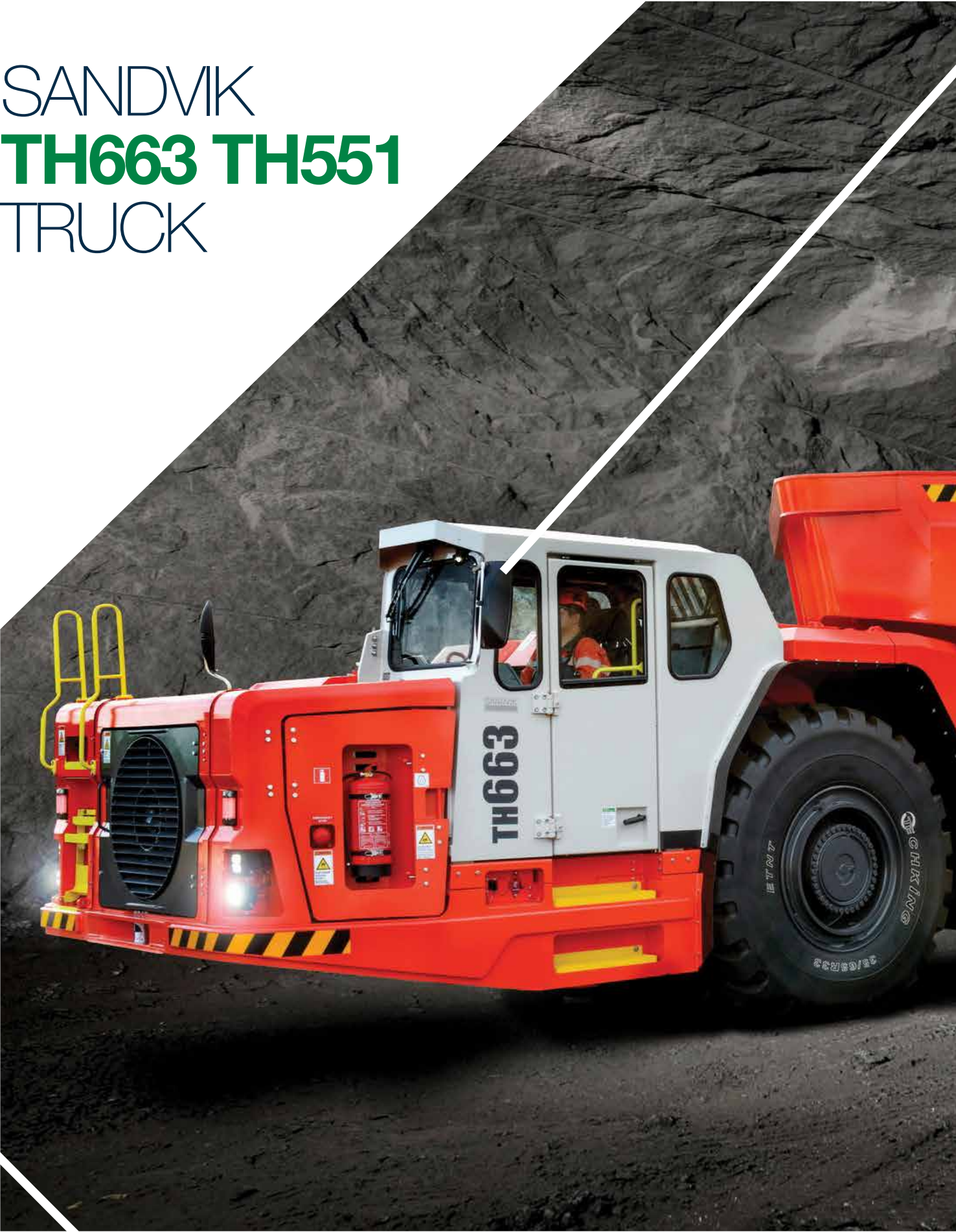

SANDVIK TH663 / TH551 Truck



5000144
BG00202032
MAIN BAR ONLY

5000142
BG00202490
MAIN BAR ONLY

5000143
BG00329584
MAIN BAR ONLY

5000136
BG00213893
MAIN BAR ONLY

5000140
BG00202252
MAIN BAR ONLY

5000137
BG00204159
MAIN BAR ONLY

5000149
BG00214267
Bracket

5000148
BG00214262
Bracket

5000149
BG00214267
Bracket

5000148
BG00214262
Bracket

5000149
BG00214267
Bracket

5000147
56209439
(214267)

5000148
BG00214262
Bracket

5000146
BG00236951
(214267)

5000145
BG00208760
MAIN BAR ONLY

5000138
BG00204183
BOTTOM BAR ONLY

5000139
BG00204240
MAIN BAR ONLY

SANDVIK TH663 / TH551 TRUCK



HANDRAIL 5000136
OEM No. BG00213893



HANDRAIL 5000137
OEM No. BG00204159



HANDRAIL 5000139
OEM No. BG00204240



HANDRAIL 5000145
OEM No. BG00208760



HANDRAIL 5000144
OEM No. BG00202032

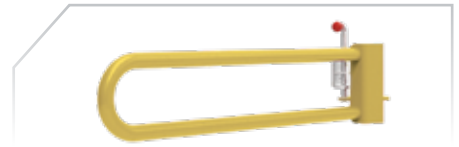

HANDRAIL 5000142
OEM No. BG00329584



LADDER 5000152
OEM No. BG00210677



HANDRAIL 5000143
OEM No. BG00202490



HANDRAIL 5000140
OEM No. BG00202252



HANDRAIL 5000138
OEM No. BG00204183



LADDER PART 5000151
OEM No. 56210006 - Step Ladder

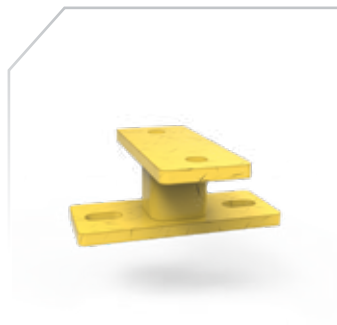

SUPPORT BRACKET PART 5000147
OEM No. 56209439



SUPPORT BRACKET PART 5000146
OEM No. BG00236951

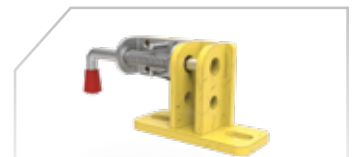

LATCH PART 5000149
OEM No. BG00214267 LH



LATCH PART 5000148
OEM No. BG00214262 RH

SANDVIK TH663 TRUCK PART NO: 5000150*
*EXCLUDES LADDER

SANDVIK TH663 / TH551 Truck

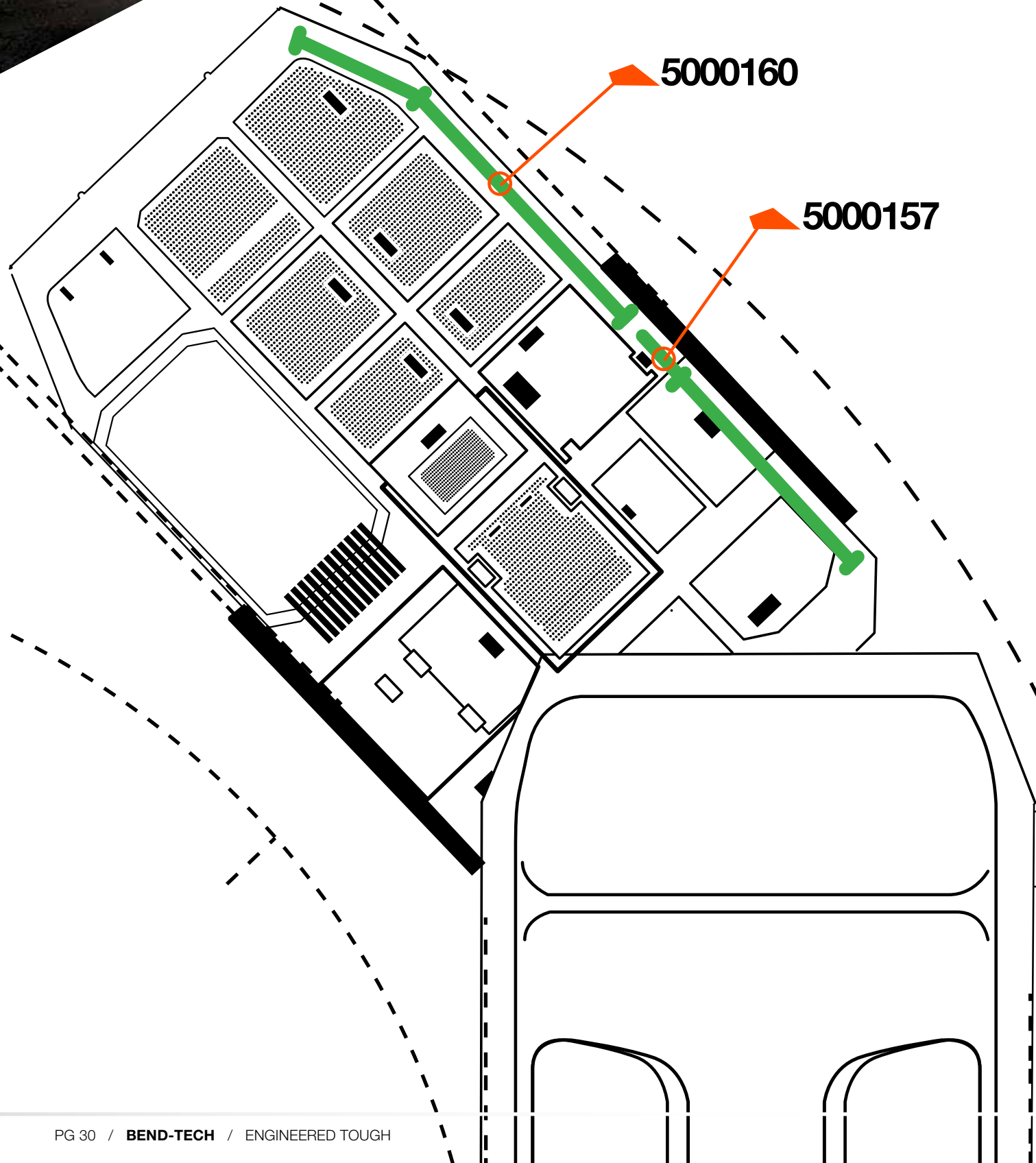

5000160

5000157

SANDVIK **TH663 / TH551** Front Low Folding Handrail

This new design has been created to avoid the damages that occur on handrails that do not fold flat on the deck.

Benefits include:

- Replaces the long mid folding rail on the right hand side of the truck
- New low-folding design
- Reduced damage to front handrails

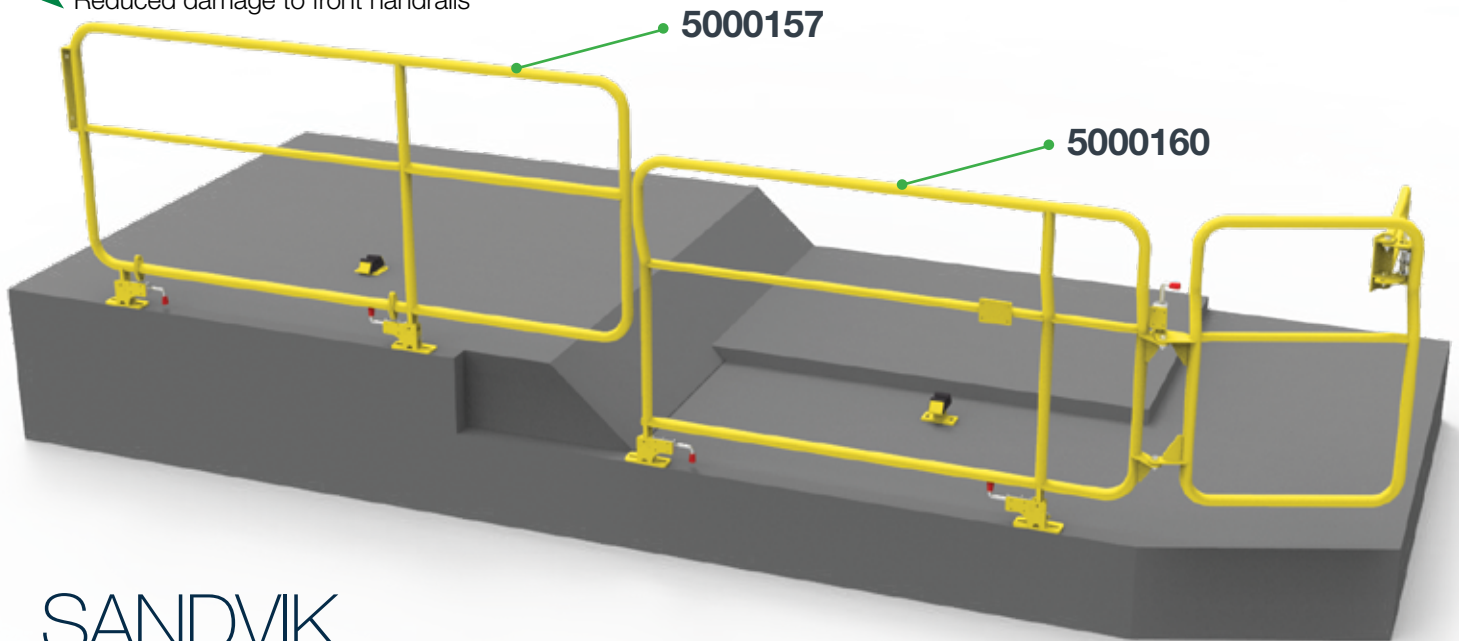

SANDVIK **TH663 / TH551** Rear Tray Protection

Benefits include:

- Designed for the TH663 and TH551 trucks to prevent falls and slips off the back of the truck when the tray is up
- Permanently fixed onto the truck
- Fold in gates ensure that the handrail setup stays compact when not in use





“ Engineered tough but light enough to carry ”

Alltuff Stands

Alltuff Stands have been engineered to transform safety and combat the failures associated with traditional work stands. Alltuff Stands are a high capacity light-weight stand with load ratings of 15T and 30T and a maximum manual handling weight of 14kg.

Available at three fixed heights:



15 Tonne Equipment Work Stand

- 500mm - 5001850
- 600mm - 5001851
- 750mm - 5001852



30 Tonne Equipment Work Stand

- 500mm - 5001853
- 600mm - 5001854
- 750mm - 5001855

Workshop Trestle Stands

Our trestle stands are engineered and certified with full compliance with Australian Standards. Designed for safe, efficient and easy site maintenance and available in lightweight aluminium or steel.

Features include:

- Removable top sacrificial section
- Certification plates and SWL markings
- Heavy duty steel or aluminium construction
- Stocked and available for immediate despatch

10T (SWL)
5001813
2400mm (w)
x 650mm (h)



2T (SWL)
5001747
1000mm (w)
x 900mm (h)



5T (SWL) 5001805
1000mm (w) x 900mm (h)
5T (SWL) 5001760
2400mm (w) x 900mm (h)



Aluminium

750kg (SWL) - 5501966

1500mm (w) x 900mm (h)

500kg (SWL) - 5502035

1200mm (w) x 900mm (h)

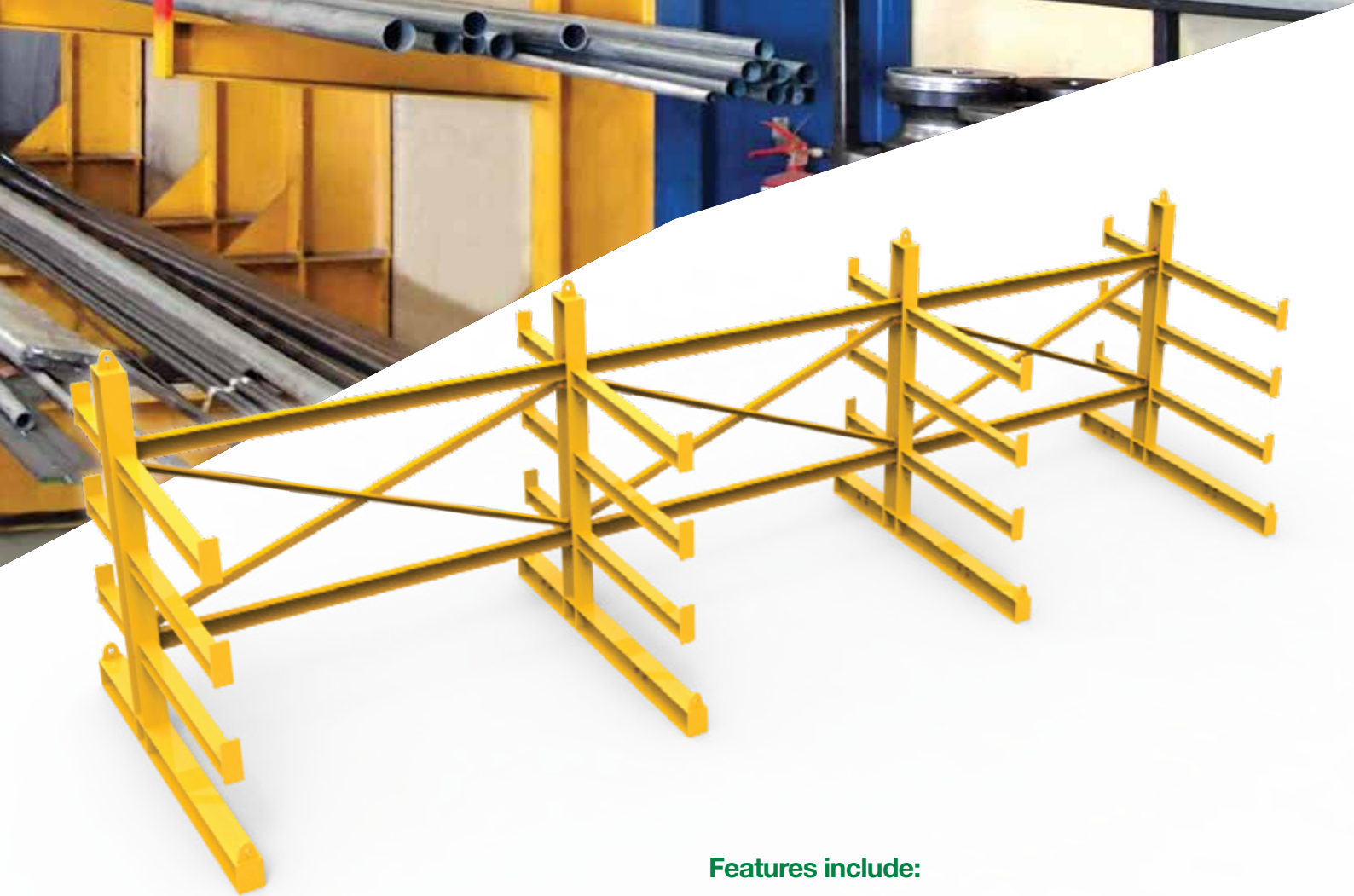

General Purpose Steel Rack

Our general-purpose steel racks are available in three standard configurations:

➤ 6m - 5000222 ➤ 7.5m - 5000221 ➤ 9m - 5000219

Features include:

- 8 shelves (4 either side)
- 3T (SWL) per shelf
- Lifting eyes for easy mobility and transport
- Modular design for ease of transport and erection on-site
- Cantilevered to provide optimum space utilisation
- Fully engineered and certified with Australian Standards
- Available in 6m, 7.5m and 9m configurations

Workshop Whiteboard Benches

Our whiteboard workbench is designed to encourage workshop efficiency and collaboration. Incorporating a large workbench, storage shelving and whiteboard provides your team with a base to work, delegate and organise.

Features include:

- Heavy duty mine specified construction
- Heavy duty castors for easy mobility
- Customisable for your specifications
- Large 1450mm whiteboard

Part No. 5001812



We offer a full consulting and engineering service

Projects and the associated challenges often require custom solutions, we take pride in our CDEC system. Consultation, Design, Engineering and Construction is our holistic approach to solution development making maintenance on-site safe, efficient and easy.

CDEC Process



Consultation We come to you and visit your site to get a hands-on feel for your project. The aim of our consultation is to listen to and understand your requirements. This approach allows us to develop and discuss with you on-site, possible solutions to your problem, and the benefits we can offer.



Design After the consultation we go back to our design team to begin the development of your custom solution. Our team produce designs in **CAD Design** complete with all drafting documentation ensuring an advanced manufacturing process. Our process allows and encourages you to be involved in the design stage and collaborate with our highly skilled team.

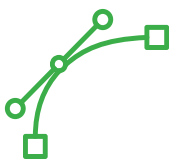

Engineering Once the design is approved we begin the development and engineering process. This ensures that the right material is used for your project to guarantee structural and functional integrity. We provide full certification that includes WLL, load ratings, integrity reports as well as certificate plates and identifications. We design and engineer all our solutions to ensure full compliance with Australian standards.



Construction Finally, once the project is ready and certified for construction we manufacture your solution. We test, machine, fabricate and surface treat as well as trial fit your custom project. We only manufacture high quality products that provide long lasting, safe and efficient solutions.



PERTH 08 9459 8600
SYDNEY 02 9764 6607
BRISBANE 07 3117 3780

KALGOORLIE 08 9021 8300
NEWMAN 08 9175 1164
MOUNT ISA 07 4743 6458

sales@bendtechgroup.com.au
www.bendtechgroup.com.au

All manufacturers names, number, symbols, photos and description are for reference purpose only and do not imply that parts listed are products of the manufacturers